

PARTS FOR MODEL TYPE DW-1Z OR DW-HZ

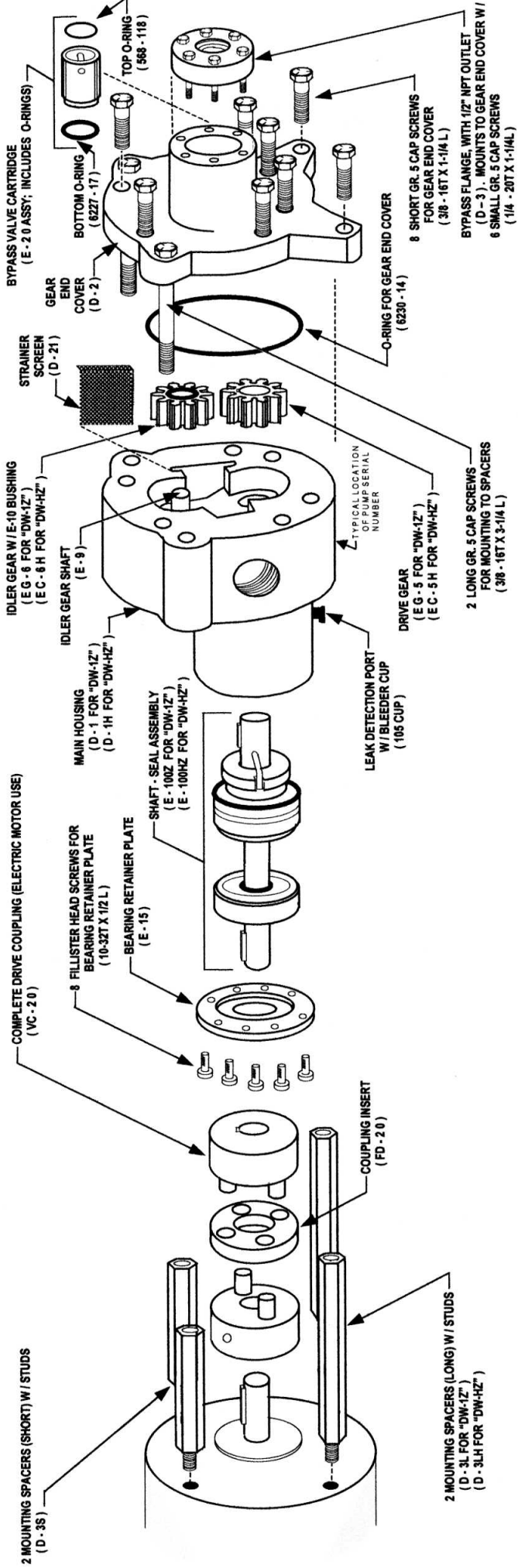

NOTES: (A) THESE PUMPS ARE PROVIDED WITH AN INTERNAL BYPASS VALVE WHICH MUST BE CONNECTED TO AN EXTERNAL LINE THROUGH THE 1/2" NPT PORT IN THE BYPASS FLANGE, MOUNTED TO THE GEAR END COVER. SEE OTHER AVAILABLE LITERATURE, OR CONTACT FACTORY FOR ADDITIONAL INFORMATION.

(B) FOR DIRECT ELECTRIC MOTOR CONNECTION, USE THE SMITH FLEXIBLE DRIVE COUPLING, AS SHOWN.

(C) THERE ARE TWO "D-SERIES" MODELS, NEITHER OF WHICH IS REVERSIBLE: THE "DW-HZ" WITH 1" NPT PORTS, AND THE "DW-1Z" WITH 3/4" NPT PORTS. TO INTERCHANGE THE POSITIONS OF THE INLET AND OUTLET, THE PUMPS MAY BE ROTATED 180°. IN MOST *INTERMITTENT DUTY* LOW VOLUME BUTANE / PROPANE TRANSFER APPLICATIONS, THESE PUMPS CAN BE SUCCESSFULLY UTILIZED UP TO THEIR MAXIMUM DESIGN SPEED (3600 RPM). SEE APPROPRIATE LITERATURE, OR CONTACT FACTORY FOR ADDITIONAL INFORMATION ON THESE AND RELATED SUBJECTS OF CONCERN.

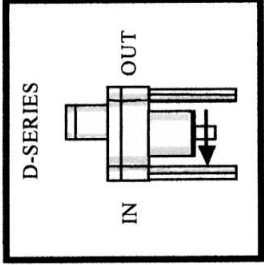

SMITH PRECISION PRODUCTS COMPANY

P.O. Box 276, Newbury Park, CA 91319 USA
1299 Lawrence Drive, Newbury Park, CA 91320 USA

Tel.: 805/498-6616 FAX: 805/499-2867

e-mail: SMPUMP1299@aol.com web: www.smithpumps.com

